

WE CARE ABOUT FOOTBALL



**UEFA Stadium Infrastructure  
Regulations  
Edition 2010**

## CONTENTS

<b>I. General provisions</b>	<b>1</b>
ARTICLE 1 - SCOPE OF APPLICATION	1
ARTICLE 2 - CONNECTION WITH COMPETITION REGULATIONS	1
ARTICLE 3 - DEFINITION OF TERMS	1
<b>II. Structural criteria applicable to all categories</b>	<b>2</b>
SECTION 1: AREAS RELATING TO PLAYERS AND OFFICIALS	2
ARTICLE 4 - FIELD OF PLAY	2
ARTICLE 5 - FLOODLIGHTING	3
ARTICLE 6 - WARM-UP AREA	3
ARTICLE 7 - GOALS AND SPARE GOAL	3
ARTICLE 8 - SUBSTITUTES' BENCHES	3
ARTICLE 9 - FLAGPOLES	3
ARTICLE 10 - DRESSING ROOMS	3
ARTICLE 11 - DELEGATE'S ROOM	4
ARTICLE 12 - FIRST-AID AND TREATMENT FACILITIES FOR PLAYERS AND OFFICIALS	4
ARTICLE 13 - DOPING CONTROL STATION	4
ARTICLE 14 - PARKING AREAS	4
SECTION 2: SPECTATOR-RELATED AREAS	5
ARTICLE 15 - STANDS AND SPECTATOR FACILITIES	5
ARTICLE 16 - VISITING SUPPORTERS	5
ARTICLE 17 - PUBLIC ACCESS AND EGRESS	5
ARTICLE 18 - EMERGENCY LIGHTING SYSTEM	5
ARTICLE 19 - PUBLIC ADDRESS SYSTEM	6
ARTICLE 20 - SANITARY FACILITIES FOR SPECTATORS	6
ARTICLE 21 - FIRST-AID FACILITIES FOR SPECTATORS	6
ARTICLE 22 - FACILITIES FOR SPECTATORS WITH DISABILITIES	6
ARTICLE 23 - VIP SEATS	6
SECTION 3: MEDIA-RELATED AREAS	6
ARTICLE 24 - MEDIA WORKING AREA	6
ARTICLE 25 - CAMERA POSITIONS	7
ARTICLE 26 - PRESS BOX	7
ARTICLE 27 - TV AND RADIO COMMENTARY POSITIONS	7
ARTICLE 28 - OB VAN AREA	7

<b>III. Category 1 structural criteria</b>	<b>8</b>
SECTION 1: AREAS RELATING TO PLAYERS AND OFFICIALS	8
ARTICLE 29 - FIELD OF PLAY	8
ARTICLE 30 - FLOODLIGHTING	8
ARTICLE 31 - PARKING AREAS	8
SECTION 2: SPECTATOR-RELATED AREAS	8
ARTICLE 32 - STANDS AND SPECTATOR FACILITIES	8
ARTICLE 33 - SPECTATOR CAPACITY	8
ARTICLE 34 - VIP SEATS	8
SECTION 3: MEDIA-RELATED AREAS	8
ARTICLE 35 - MEDIA WORKING AREA	8
ARTICLE 36 - MAIN CAMERA PLATFORM	8
ARTICLE 37 - PRESS BOX	9
ARTICLE 38 - TV AND RADIO COMMENTARY POSITIONS	9
ARTICLE 39 - TV STUDIOS	9
ARTICLE 40 - OB VAN AREA	9
ARTICLE 41 - PRESS CONFERENCE ROOM	9
<b>IV. Category 2 structural criteria</b>	<b>9</b>
SECTION 1: AREAS RELATING TO PLAYERS AND OFFICIALS	9
ARTICLE 42 - FIELD OF PLAY	9
ARTICLE 43 - FLOODLIGHTING	9
ARTICLE 44 - PARKING AREAS	10
SECTION 2: SPECTATOR-RELATED AREAS	10
ARTICLE 45 - STANDS AND SPECTATOR FACILITIES	10
ARTICLE 46 - SPECTATOR CAPACITY	10
ARTICLE 47 - CONTROL ROOM	10
ARTICLE 48 - VIP SEATS	10
SECTION 3: MEDIA-RELATED AREAS	10
ARTICLE 49 - MEDIA WORKING AREA	10
ARTICLE 50 - MAIN CAMERA PLATFORM	10
ARTICLE 51 - PRESS BOX	10
ARTICLE 52 - TV AND RADIO COMMENTARY POSITIONS	10
ARTICLE 53 - TV STUDIOS	10
ARTICLE 54 - OB VAN AREA	11
ARTICLE 55 - PRESS CONFERENCE ROOM AND MIXED ZONE	11
<b>V. Category 3 structural criteria</b>	<b>11</b>
SECTION 1: AREAS RELATING TO PLAYERS AND OFFICIALS	11
ARTICLE 56 - FIELD OF PLAY	11

ARTICLE 57 -	DRESSING ROOMS	11
ARTICLE 58 -	FLOODLIGHTING	11
ARTICLE 59 -	PARKING AREA	11
SECTION 2:	SPECTATOR-RELATED AREAS	12
ARTICLE 60 -	STANDS AND SPECTATOR FACILITIES	12
ARTICLE 61 -	SPECTATOR CAPACITY	12
ARTICLE 62 -	CONTROL ROOM	12
ARTICLE 63 -	VIP SEATS	12
SECTION 3:	MEDIA-RELATED AREAS	12
ARTICLE 64 -	MEDIA WORKING AREA	12
ARTICLE 65 -	MAIN CAMERA PLATFORM	12
ARTICLE 66 -	PRESS BOX	12
ARTICLE 67 -	TV AND RADIO COMMENTARY POSITIONS	12
ARTICLE 68 -	TV STUDIOS	12
ARTICLE 69 -	OB VAN AREA	12
ARTICLE 70 -	PRESS CONFERENCE ROOM AND MIXED ZONE	13
<b>VI. Category 4 structural criteria</b>		<b>13</b>
SECTION 1:	AREAS RELATING TO PLAYERS AND OFFICIALS	13
ARTICLE 71 -	FIELD OF PLAY	13
ARTICLE 72 -	DRESSING ROOMS	13
ARTICLE 73 -	FLOODLIGHTING	13
ARTICLE 74 -	PARKING AREAS	13
SECTION 2:	SPECTATOR-RELATED AREAS	14
ARTICLE 75 -	STANDS AND SPECTATOR FACILITIES	14
ARTICLE 76 -	PUBLIC ACCESS AND EGRESS	14
ARTICLE 77 -	SPECTATOR CAPACITY	14
ARTICLE 78 -	CONTROL ROOM	14
ARTICLE 79 -	CLOSED-CIRCUIT TELEVISION SYSTEM	14
ARTICLE 80 -	VIP SEATS AND HOSPITALITY AREAS	14
SECTION 3:	MEDIA-RELATED AREAS	14
ARTICLE 81 -	MEDIA WORKING AREA	14
ARTICLE 82 -	MAIN CAMERA PLATFORM	15
ARTICLE 83 -	PRESS BOX	15
ARTICLE 84 -	TV AND RADIO COMMENTARY POSITIONS	15
ARTICLE 85 -	TV STUDIOS	15
ARTICLE 86 -	OB VAN AREA	15
ARTICLE 87 -	PRESS CONFERENCE ROOM AND MIXED ZONE	15

<b>VII. Final provisions</b>	<b>15</b>
ARTICLE 88 - DISCIPLINARY PROCEDURES	15
ARTICLE 89 - ANNEXES	15
ARTICLE 90 - AUTHORITATIVE TEXT	16
ARTICLE 91 - ADOPTION AND ENTRY INTO FORCE	16
ANNEX I: CALCULATION OF THE FLOODLIGHTING AVERAGE ILLUMINANCE	17
ANNEX II: PLAN OF DOPING CONTROL STATION	18

## *Preamble*

Based on Article 50(1) of the *UEFA Statutes*, the following regulations have been adopted.

## **I. General provisions**

### **Article 1 - Scope of application**

---

- 1 These regulations govern the structural criteria to be fulfilled by a stadium in order for it to be classified (in ascending rank order) as UEFA category 1, 2, 3 or 4.
- 2 The criteria defined in chapter II of these regulations are applicable to all UEFA stadium categories. The criteria applicable to each category individually (as defined in chapters III to VI) apply in addition.
- 3 These regulations do not affect the legal obligations arising from national legislation applicable to stadium facilities.

### **Article 2 - Connection with competition regulations**

---

The relevant UEFA regulations governing a competition to be played in a stadium:

- a) specify the category of stadium required for all matches in the competition concerned;
- b) set out the responsibilities for monitoring compliance with the criteria for the required category;
- c) may specify conditions under which the UEFA administration may grant an exception to a specific structural criterion for the required stadium category.

### **Article 3 - Definition of terms**

---

- 1 For the purpose of these regulations, the following definitions apply:
  - a) Closed-circuit television system: surveillance cameras with pan, tilt and zoom functions for monitoring spectators, stadium approaches and entrances, and all viewing areas within the stadium.
  - b) Control room: room reserved for the persons who have overall responsibility for all match-related safety and security matters, namely the chief police officer, the stadium security officer and their staff.
  - c) Delegate's room: room reserved for the official UEFA match delegate and referee observer.
  - d) Flash interview position: area between the pitch and the dressing rooms, where live TV and radio interviews can be conducted.
  - e) Football turf: artificial turf used to surface a football field.

- f) Mixed zone: area between the dressing rooms and the parking area reserved for the team buses, where accredited written press, radio and TV reporters can interview players after the match.
  - g) OB van area: secure area for parking TV companies' outside broadcast vans.
  - h) Public address system: electronic system of loudspeakers capable of conveying spoken messages to all areas of the stadium instantaneously.
  - i) Standing accommodation: areas with benches, sectors for standing spectators or terraces without seats.
  - j) Temporary stands: seating which, by virtue of its material, design and construction, is clearly intended for use for a very limited period and is not fixed to a suitable load-bearing foundation.
- <sup>2</sup> In these regulations, the use of the masculine form refers equally to the feminine.

## **II. Structural criteria applicable to all categories**

### **Section 1: Areas relating to players and officials**

#### **Article 4 - *Field of play***

---

- <sup>1</sup> The field of play must be smooth and level.
- <sup>2</sup> The stadium must be equipped with either a natural playing surface or football turf.
- <sup>3</sup> Football turf must meet all of the following conditions:
  - a) it must have been granted the required FIFA licence, which can only be delivered after the turf in question has been tested by a FIFA-accredited laboratory as meeting the FIFA quality standards for football turf;
  - b) it must meet all the requirements of the national legislation in force;
  - c) its surface must be green and marked in white.
- <sup>4</sup> The field of play must be equipped with a drainage system so that it cannot become unplayable due to flooding.
- <sup>5</sup> The stadium must be equipped with facilities, such as pitch heating, to ensure that the field of play is playable on any matchday during the whole UEFA competition season.
- <sup>6</sup> No object can be located less than 21m above the field of play.

### **Article 5 - Floodlighting**

---

For matches that are not being broadcast, the stadium must be equipped with a floodlighting system maintaining a minimum average illuminance of 350 E<sub>v</sub>(lx) towards the main stand (calculated according to Annex I).

### **Article 6 - Warm-up area**

---

A warm-up area for substitutes must be available along the touchlines or behind the advertising boards behind the goal.

### **Article 7 - Goals and spare goal**

---

- 1 Goalposts and crossbars must be made out of aluminium or similar material and must be round or elliptical. Moreover, they must be in compliance with the Laws of the Game as promulgated by the International Football Association Board (IFAB), which means, in particular, that:
  - a) the distance between the posts must be 7.32m;
  - b) the distance from the lower edge of the crossbar to the ground must be 2.44m;
  - c) the goalposts and crossbars must be white;
  - d) they must not pose any danger to players.
- 2 A spare goal, which can be easily installed if the circumstances so require, must be available within the stadium.

### **Article 8 - Substitutes' benches**

---

The stadium must be equipped with two covered benches at pitch level, each with seating room for at least 13 people and positioned at least 5m from the touchline.

### **Article 9 - Flagpoles**

---

The stadium must be equipped with a minimum of five flagpoles or other kind of supports allowing five flags to be flown at the stadium.

### **Article 10 - Dressing rooms**

---

- 1 The stadium must be equipped with:
  - a) a dressing room for each team with a minimum of five showers, three individual seated toilets, seating for at least 25 people, one massage table and one tactical board;
  - b) a referees' dressing room with a minimum of one shower, one individual seated toilet, five seats and a desk.



- 2 The stadium must guarantee direct, private and secure access for both teams and the referees from their dressing rooms to the playing area and ensure their safe arrival at/departure from the stadium.

#### **Article 11 - Delegate's room**

---

The stadium must be equipped with a delegate's room with access to communication facilities such as a phone, fax and internet connection located nearby, and with easy access to the team and referees' dressing rooms.

#### **Article 12 - First-aid and treatment facilities for players and officials**

---

The stadium must be equipped with a dedicated room for first aid and medical treatment of players and officials.

#### **Article 13 - Doping control station**

---

- 1 The stadium must be equipped with a dedicated doping control station which meets the requirements set out in Annex II of these regulations.
- 2 The doping control station must be near the team dressing rooms and inaccessible to the public and the media.
- 3 It must be at least 20m<sup>2</sup> and comprise a waiting room, testing room and toilet area, all adjoining.
- 4 The waiting room must form part of or be immediately adjacent to the testing room (a partition dividing the two areas is also acceptable). It must contain sufficient seating for eight people, clothes-hanging facilities or lockers, and a refrigerator.
- 5 The testing room must contain one table, four chairs, a sink with running water, a lockable cabinet and a toilet area (adjacent to the room or in the room itself).
- 6 The toilet area must be within the testing room, or immediately adjacent and with direct private access to the testing room. It must contain a seated toilet, a sink with running water and, if possible, a shower.

#### **Article 14 - Parking areas**

---

- 1 Parking space for a minimum of two buses and ten cars must be available for the teams and officials.
- 2 This parking space must be located in a safe and secure area in the immediate vicinity of the players' and officials' areas.

## **Section 2: Spectator-related areas**

### **Article 15 - *Stands and spectator facilities***

---

- 1 Seats for spectators must be individual, fixed (e.g. to the floor), separated from one another, shaped, numbered, made of an unbreakable and non-flammable material, and have a backrest of a minimum height of 30cm when measured from the seat.
- 2 The use of temporary stands is prohibited.
- 3 The stadium must be equipped with refreshment and catering facilities for all spectators in every sector of the stadium.

### **Article 16 - *Visiting supporters***

---

At least five per cent of the total stadium capacity must be available exclusively for visiting supporters in a segregated area of the stadium.

### **Article 17 - *Public access and egress***

---

- 1 Entry gates and/or turnstiles must be designed in such a way as to avoid congestion and ensure the smooth flow of crowds.
- 2 All public circulation areas, access and egress routes in each sector must be clearly distinguished from the seating areas. All exit doors and gates leading out of the stadium must be clearly indicated and signposted (for example by means of internationally understandable pictograms).
- 3 All exit doors and gates in the stadium, and all gates leading from the spectator areas into the playing area, must:
  - a) be designed to remain unlocked (but their usage is manned) while spectators are in the stadium;
  - b) open outwards in the direction of the egress and evacuation routes.
- 4 Approaches to the stadium must be adequately signposted (for example by means of internationally understandable pictograms) to guide spectators to their sectors. Entry gates, exit gates and doors must be operational and similarly clearly indicated by signs which are universally understood.

### **Article 18 - *Emergency lighting system***

---

For the purposes of ensuring safety and guiding spectators and staff, the stadium must be equipped with an emergency lighting system approved by the competent local authorities for use in the event of a general lighting failure in any part of the stadium to which the public or staff have access, including all egress and evacuation routes.

### **Article 19 - Public address system**

---

- 1 The stadium must be equipped with a public address system.
- 2 The public address system must cover both the inside and the outside of the stadium and be secured against failures of the main power supply.

### **Article 20 - Sanitary facilities for spectators**

---

- 1 Sufficient clean and hygienic sanitary facilities must be distributed evenly throughout all sectors of the stadium. Toilets and urinals must be equipped with flushers. Sinks and amenities such as toilet paper and soap must be available.
- 2 The minimum requirement for sanitary facilities are the following, based on an 80:20 ratio of male and female:
  - a) 1 seated toilets per 250 males;
  - b) 1 urinal per 125 males;
  - c) 1 seated toilet per 125 females.

### **Article 21 - First-aid facilities for spectators**

---

- 1 Fully equipped first-aid facilities approved by the competent local authorities must be available for spectators in each sector of the stadium.
- 2 These facilities must be clearly identified and access to them must be clearly signposted.

### **Article 22 - Facilities for spectators with disabilities**

---

- 1 The stadium must have dedicated access and seats for spectators with disabilities and their helpers.
- 2 In addition, persons with disabilities must have dedicated sanitary facilities as well as refreshment and catering facilities nearby.
- 3 One disabled toilet must be available for every 15 wheelchair users.

### **Article 23 - VIP seats**

---

The VIP seats must be covered, in the grandstand and as close to the halfway line as possible, between the two penalty areas.

## **Section 3: Media-related areas**

### **Article 24 - Media working area**

---

At least one room equipped with desks, power supply and phone/internet connections must be provided for media representatives.

### **Article 25 - Camera positions**

---

- 1 One main camera platform must be provided in the grandstand. It must be centrally situated, at a height above the pitch which guarantees optimum picture quality.
- 2 The main camera position must be exactly in line with the halfway line and be at a height which forms an angle of 15-20° from the horizontal plane to the centre spot.

### **Article 26 - Press box**

---

- 1 The press box must be covered and centrally located in the main grandstand. It must have an unobstructed view of the entire playing area and easy access to the other media areas.
- 2 In the press box, all seats with desks must be equipped with a power supply and phone/internet connections.
- 3 The desks must be big enough to accommodate a laptop computer and a notepad.

### **Article 27 - TV and radio commentary positions**

---

- 1 Commentary positions must be covered and centrally located in the main grandstand. They must have an unobstructed view of the entire playing area and easy access to the other media areas.
- 2 Each commentary position must consist of a desk with power supply and at least three seats.
- 3 At least one commentary position must be equipped with dedicated broadband internet access.

### **Article 28 - OB van area**

---

- 1 The OB van area must be located as close as possible to the stadium, ideally on the same side as the main camera platform, on even and solid ground and with a power supply available.
- 2 It must either provide a clear, unobstructed view of the southern horizon, or a separate satellite uplink area is required no more than 50m from the centre of the OB van area.

### **III. Category 1 structural criteria**

#### **Section 1: Areas relating to players and officials**

##### **Article 29 - *Field of play***

---

The field of play must be:

- a) 100–105m long; and
- b) 64–68m wide.

##### **Article 30 - *Floodlighting***

---

For matches that are being broadcast, the stadium must be equipped with a floodlighting system that allows the host broadcaster to ensure adequate broadcasting of the match.

##### **Article 31 - *Parking areas***

---

A minimum of 20 VIP parking spaces must be available in a safe and secure area.

#### **Section 2: Spectator-related areas**

##### **Article 32 - *Stands and spectator facilities***

---

Standing accommodation as defined at Article 3(1) (i) is permitted.

##### **Article 33 - *Spectator capacity***

---

The stadium must have a capacity of at least 200 spectators.

##### **Article 34 - *VIP seats***

---

The stadium must have at least 50 VIP seats, 10 of which must be reserved for the visiting team.

#### **Section 3: Media-related areas**

##### **Article 35 - *Media working area***

---

The media working area must be at least 50m<sup>2</sup>.

##### **Article 36 - *Main camera platform***

---

The platform for the main camera must be at least 4m<sup>2</sup>, to accommodate at least one camera.

### **Article 37 - Press box**

---

The press box for media representatives must have at least 20 seats, 5 of which must be equipped with desks.

### **Article 38 - TV and radio commentary positions**

---

The stadium must have at least two TV and radio commentary positions.

### **Article 39 - TV studios**

---

The stadium must be equipped with at least one room that can be converted into a TV studio.

### **Article 40 - OB van area**

---

The stadium must have an OB van area measuring at least 100m<sup>2</sup>.

### **Article 41 - Press conference room**

---

The press conference room must be located within the stadium. If the media working area is within the stadium, the press conference room may be part of this area.

## **IV. Category 2 structural criteria**

### **Section 1: Areas relating to players and officials**

#### **Article 42 - Field of play**

---

The field of play must be:

- a) 100–105m long; and
- b) 64–68m wide.

#### **Article 43 - Floodlighting**

---

<sup>1</sup> For matches that are being broadcast, the stadium must be equipped with a floodlighting system maintaining the following minimum average illuminance (calculated according to Annex I):

- a) 800 E<sub>v</sub>(lx) towards fixed cameras
- b) 500 E<sub>v</sub>(lx) towards mobile cameras

<sup>2</sup> In order to ensure that the match can proceed in the event of a power failure, an independent backup power supply able to provide at least two-thirds of the equivalent light intensity values must be available.

#### **Article 44 - *Parking areas***

---

A minimum of 50 VIP parking spaces must be available in a safe and secure area.

### **Section 2: *Spectator-related areas***

#### **Article 45 - *Stands and spectator facilities***

---

Any standing accommodation as defined in Article 3(1) (i) is prohibited.

#### **Article 46 - *Spectator capacity***

---

The stadium must have a capacity of at least 1,500 seats.

#### **Article 47 - *Control room***

---

The stadium must have a control room that provides a good overview of the inside of the stadium and is equipped with communication facilities.

#### **Article 48 - *VIP seats***

---

The stadium must have at least 100 VIP seats, 20 of which must be reserved for the visiting team.

### **Section 3: *Media-related areas***

#### **Article 49 - *Media working area***

---

The media working area must be at least 100m<sup>2</sup>, to accommodate a minimum of 50 media representatives.

#### **Article 50 - *Main camera platform***

---

The main camera platform must be at least 6m<sup>2</sup>, to accommodate two cameras.

#### **Article 51 - *Press box***

---

The press box for media representatives must have at least 20 covered seats, 10 of which must be equipped with desks.

#### **Article 52 - *TV and radio commentary positions***

---

The stadium must have at least three TV and radio commentary positions.

#### **Article 53 - *TV studios***

---

The stadium must be equipped with at least one TV studio 5m long x 5m wide x 2.3m high.

#### **Article 54 - OB van area**

---

The stadium must have an OB van area measuring at least 200m<sup>2</sup>.

#### **Article 55 - Press conference room and mixed zone**

---

- 1 Within the stadium, a press conference room or a dedicated section of the media working area must be available, equipped with a desk, camera platform, podium, split box, sound system and chairs.
- 2 This room or section must have at least 30 seats for the media representatives.
- 3 A space must be available between the dressing rooms and the parking area reserved for the team buses that can be converted into a mixed zone.

### **V. Category 3 structural criteria**

#### **Section 1: Areas relating to players and officials**

##### **Article 56 - Field of play**

---

The field of play must be:

- a) 105m long; and
- b) 68m wide.

##### **Article 57 - Dressing rooms**

---

The stadium must be equipped with a referees' dressing room measuring at least 20m<sup>2</sup>, with a minimum of two showers, one individual seated toilet, six seats and a desk.

##### **Article 58 - Floodlighting**

---

- 1 For matches that are being broadcast, the stadium must be equipped with a floodlighting system maintaining the following minimum average illuminance (calculated according to Annex I):
  - a) 1200 E<sub>v</sub>(lx) towards fixed cameras
  - b) 800 E<sub>v</sub>(lx) towards mobile cameras
- 2 In order to ensure that the match can proceed in the event of a power failure, an independent backup power supply able to provide at least two-thirds of the equivalent light intensity values must be available.

##### **Article 59 - Parking area**

---

A minimum of 100 VIP parking spaces must be available in a safe and secure area.



## **Section 2: Spectator-related areas**

### **Article 60 - *Stands and spectator facilities***

---

Any standing accommodation as defined in Article 3(1) (i) is prohibited.

### **Article 61 - *Spectator capacity***

---

The stadium must have a capacity of at least 4,500 seats.

### **Article 62 - *Control room***

---

The stadium must have a control room that provides a good overview of the inside of the stadium and is equipped with communication facilities.

### **Article 63 - *VIP seats***

---

The stadium must have at least 250 VIP seats, 50 of which must be reserved for the visiting team.

## **Section 3: Media-related areas**

### **Article 64 - *Media working area***

---

- <sup>1</sup> The media working area must be at least 100m<sup>2</sup>, to accommodate a minimum of 50 media representatives.
- <sup>2</sup> Dedicated space must be provided for at least 15 photographers, if possible in a separate, fully equipped working area.

### **Article 65 - *Main camera platform***

---

The main camera platform must be at least 6m<sup>2</sup>, to accommodate two cameras.

### **Article 66 - *Press box***

---

The press box for media representatives must have at least 50 covered seats, 25 of which must be equipped with desks.

### **Article 67 - *TV and radio commentary positions***

---

The stadium must have at least five TV and radio commentary positions.

### **Article 68 - *TV studios***

---

The stadium must be equipped with at least two TV studios 5m long x 5m wide x 2.3m high.

### **Article 69 - *OB van area***

---

The stadium must have an OB van area measuring at least 200m<sup>2</sup>.

### **Article 70 - Press conference room and mixed zone**

---

- 1 Within the stadium, a press conference room or a dedicated section of the media working area must be available, equipped with a desk, camera platform, podium, split box, sound system and chairs.
- 2 This room or section must have at least 50 seats for the media representatives.
- 3 A space must be available between the dressing rooms and the parking area reserved for the team buses that can be converted into a mixed zone.

## **VI. Category 4 structural criteria**

### **Section 1: Areas relating to players and officials**

#### **Article 71 - Field of play**

---

The field of play must be:

- a) 105m long; and
- b) 68m wide.

#### **Article 72 - Dressing rooms**

---

The stadium must be equipped with a referees' dressing room measuring at least 20m<sup>2</sup>, with a minimum of two showers, one individual seated toilet, six seats and a desk.

#### **Article 73 - Floodlighting**

---

- 1 For a broadcasted match, the stadium must be equipped with a floodlighting system maintaining a minimum average illuminance of 1400 E<sub>v</sub>(lx) towards fixed camera positions (calculated according to Annex I). Lighting must uniformly cover every area of the playing field, including the corners.
- 2 In order to ensure that the match can proceed in the event of a power failure, an independent backup power supply able to provide 800 E<sub>v</sub>(lx) must be available (calculated according to Annex I).

#### **Article 74 - Parking areas**

---

A minimum of 150 VIP parking spaces must be available in a safe and secure area.

## **Section 2: Spectator-related areas**

### **Article 75 - *Stands and spectator facilities***

---

Any standing accommodation as defined in Article 3(1) (i) is prohibited.

### **Article 76 - *Public access and egress***

---

The stadium must be equipped with modern electronic access controls and mechanical counting systems delivering real-time data analysis and preventing the use of counterfeit tickets and overcrowding.

### **Article 77 - *Spectator capacity***

---

The stadium must have a capacity of at least 8,000 seats.

### **Article 78 - *Control room***

---

The stadium must have a control room that provides a good overview of the inside of the stadium and is equipped with communication facilities.

### **Article 79 - *Closed-circuit television system***

---

- 1 The stadium must be equipped, both inside and outside, with a permanent closed-circuit television system.
- 2 The closed-circuit television system must have the inbuilt facility to take still pictures and include colour monitors in the control room.

### **Article 80 - *VIP seats and hospitality areas***

---

- 1 The stadium must have at least 500 VIP seats, 100 of which must be reserved for the visiting team.
- 2 There must be a single, exclusive hospitality area of at least 400m<sup>2</sup> located as close as possible to the VIP seats.

## **Section 3: Media-related areas**

### **Article 81 - *Media working area***

---

- 1 The media working area must be at least 200m<sup>2</sup>, to accommodate a minimum of 75 media representatives.
- 2 Dedicated space must be provided for at least 25 photographers, if possible in a separate, fully equipped working area.

---

**Article 82 - Main camera platform**

---

The main camera platform must be at least 10m<sup>2</sup>, to accommodate four cameras.

---

**Article 83 - Press box**

---

The press box for media representatives must have at least 100 covered seats, 50 of which must be equipped with desks.

---

**Article 84 - TV and radio commentary positions**

---

The stadium must have at least 25 TV and radio commentary positions.

---

**Article 85 - TV studios**

---

- 1 The stadium must be equipped with at least two TV studios 5m long x 5m wide x 2.3m high. At least one of them must be a presentation studio with a view of the pitch.
- 2 Space for at least four flash interview positions (each measuring 2.5m long x 2.5m wide) must be available.

---

**Article 86 - OB van area**

---

The stadium must have an OB van area measuring at least 1,000m<sup>2</sup>.

---

**Article 87 - Press conference room and mixed zone**

---

- 1 Within the stadium, a press conference room must be available, equipped with a desk, camera platform, podium, split box, sound system and chairs.
- 2 This room must have a minimum of 75 seats for the media representatives.
- 3 The mixed zone must be covered and have a capacity for at least 50 media representatives.

## **VII. Final provisions**

---

**Article 88 - Disciplinary procedures**

---

Any breach of these regulations may be penalised by UEFA in accordance with the *UEFA Disciplinary Regulations*.

---

**Article 89 - Annexes**

---

All annexes to the present regulations form an integral part thereof.

**Article 90 - Authoritative text**

---

In case of any discrepancy in the interpretation of the English, French or German versions of these regulations, the English version prevails.

**Article 91 - Adoption and entry into force**

---

<sup>1</sup> These regulations were adopted by the UEFA Executive Committee at its meeting on 24 March 2010.

<sup>2</sup> They come into force on 1<sup>st</sup> May 2010.

For the UEFA Executive Committee:

Michel Platini  
President

Gianni Infantino  
General Secretary

Nyon, 24 March 2010

## ANNEX I: Calculation of the floodlighting average illuminance

(see Articles 5, 43(1), 58(1), 73(1) and 73(2))

The floodlighting average illuminance corresponds to the vertical illuminance with a uniformity of  $E_{\min}/E_{\max} \geq 0.4$  and  $E_{\min}/E_{\text{med}} \geq 0.6$ .

For this calculation, the following abbreviations apply:

Symbol or abbreviation	Term	Explanation
$E_{\min}/E_{\max}$ $E_{\min}/E_{\text{med}}$	Illuminance uniformity	Ratios describing how evenly light is distributed over the pitch surface.
E	Illuminance	The quantity of light falling (incident) on a surface at a specific point, expressed in lux.
$E_v$	Vertical illuminance	Illuminance on a vertical plane 1.5m above the pitch (orientation towards a specific camera).
lx	Lux	The unit of illuminance incident on a pitch surface ( $1\text{lx} = 1\text{lm}/\text{m}^2$ ).
lm	Lumen	The spectral power distribution of a lamp weighted by the eye sensitivity curve.

## ANNEX II: Plan of doping control station

(see Article 13(1))

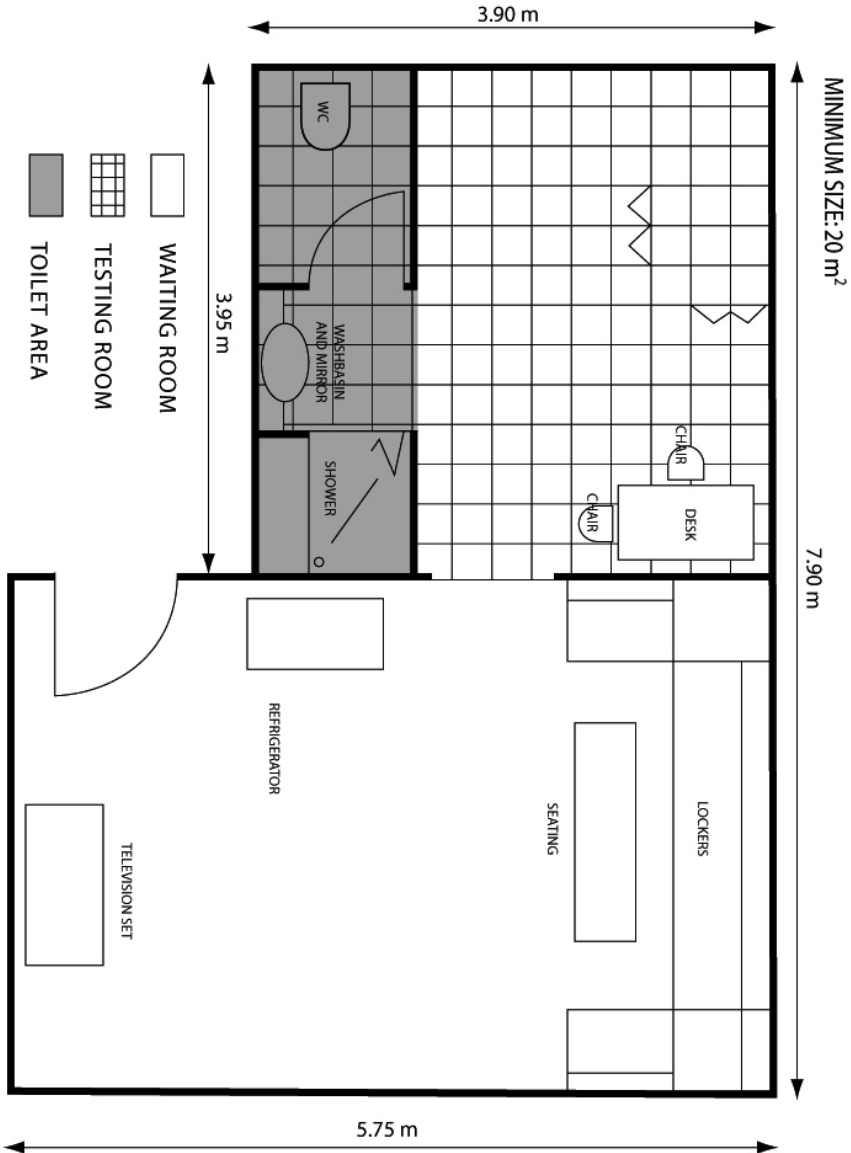

UEFA  
Route de Genève 46  
CH-1260 Nyon 2  
Switzerland  
Telephone +41 848 00 27 27  
Telefax +41 848 01 27 27  
uefa.com

Union des associations  
européennes de football

